

# BLUE ONYX RESIDENCY

LIVE IN PEACE AT FULJHORE



Presented & Developed By



BLUE ONYX PVT. LTD.



20 Units of G+5 Storied  
2/3 BHK Apartment  
With Commercial Spaces  
at Ground Floor



**SECURITY**

24 x 7 Security Service



24 x 7 DG Power Backup



24 x 7 Drinking Water

### Area Statement

Type	BHK	Carpet Area	Built Up Area	Super Built Up Area
A	3 BHK	704.24	801.41	1065
B	2 BHK	639.57	715.54	952
C	3 BHK	722.86	811.73	1079
D	2 BHK	663.78	744.71	991

\* All areas mentioned in above table are measured in Sq. Ft.

### Furniture Layout

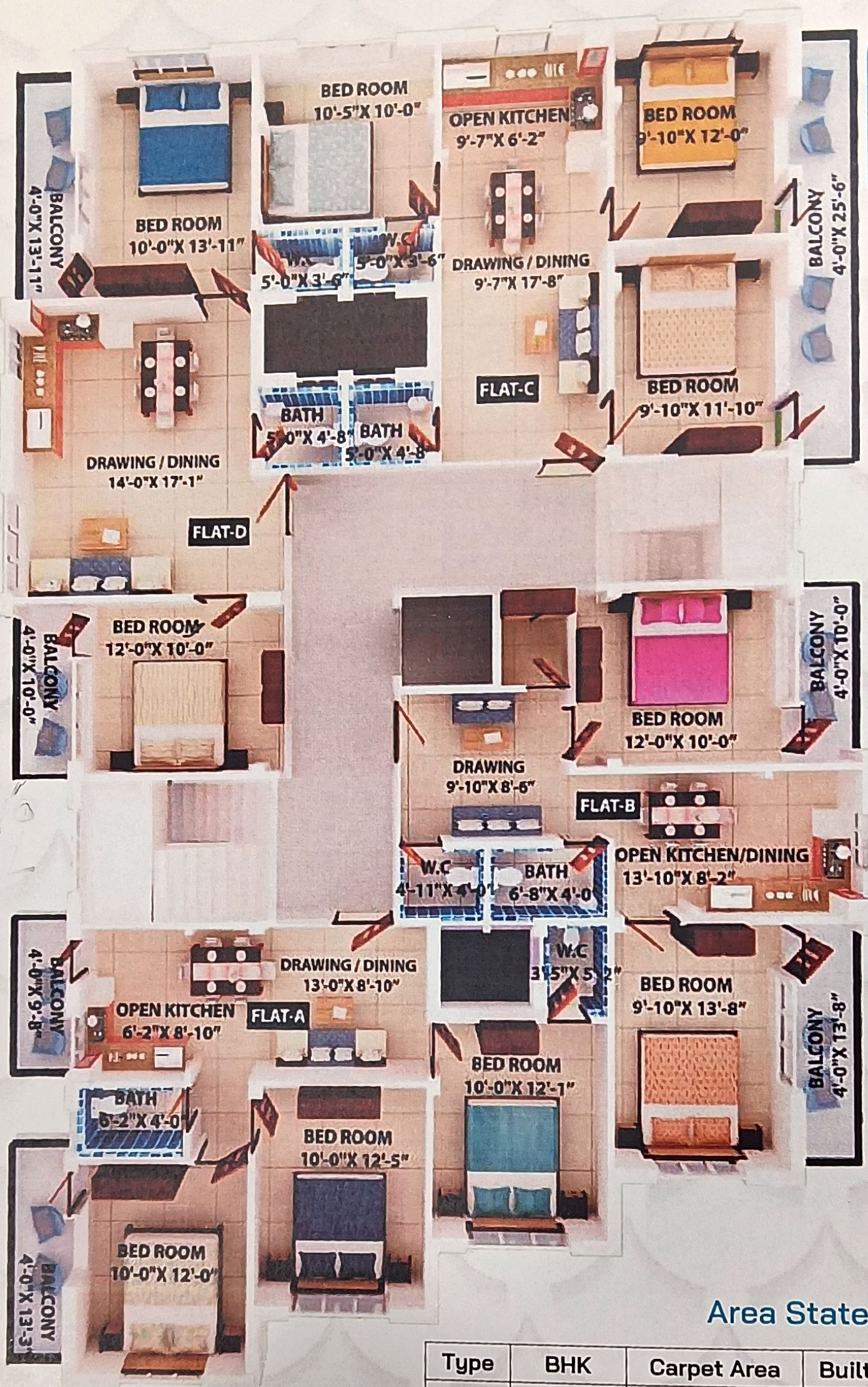



## Specifications

1. **Structure** - RR framed structure with ISI marked cement & steel.
2. **Flooring** - Vitrified tiles bedrooms and living/ Dinning, Ceramic tiles in toilet floors & skirting upto 6" from floor.
3. **Kitchen** - Granite / Marble cooking top with ceramic tiles in walls & floor.
4. **Doors** - Main door Sal wood, Standard flush door in room, PVC frame & shutter in toilets.
5. **Windows** - Anodized aluminum sliding windows & smoked glass.
6. **Electrical** - Concealed wiring with wires & fittings of ISI brand.
7. **Plumbing** - Concealed pipelines with pipes & fittings of reputed brand.
8. **Interior** - Finished with wall putty & interior primer.
10. **Exterior** - Finished with weather coat paint of reputed brand.
11. **Lift** - high passenger lift of reputed brand.



Lightning Arrester System



Ample Car Parking Space



Modern Toilets



High Speed Modern Elevator





## Site Map

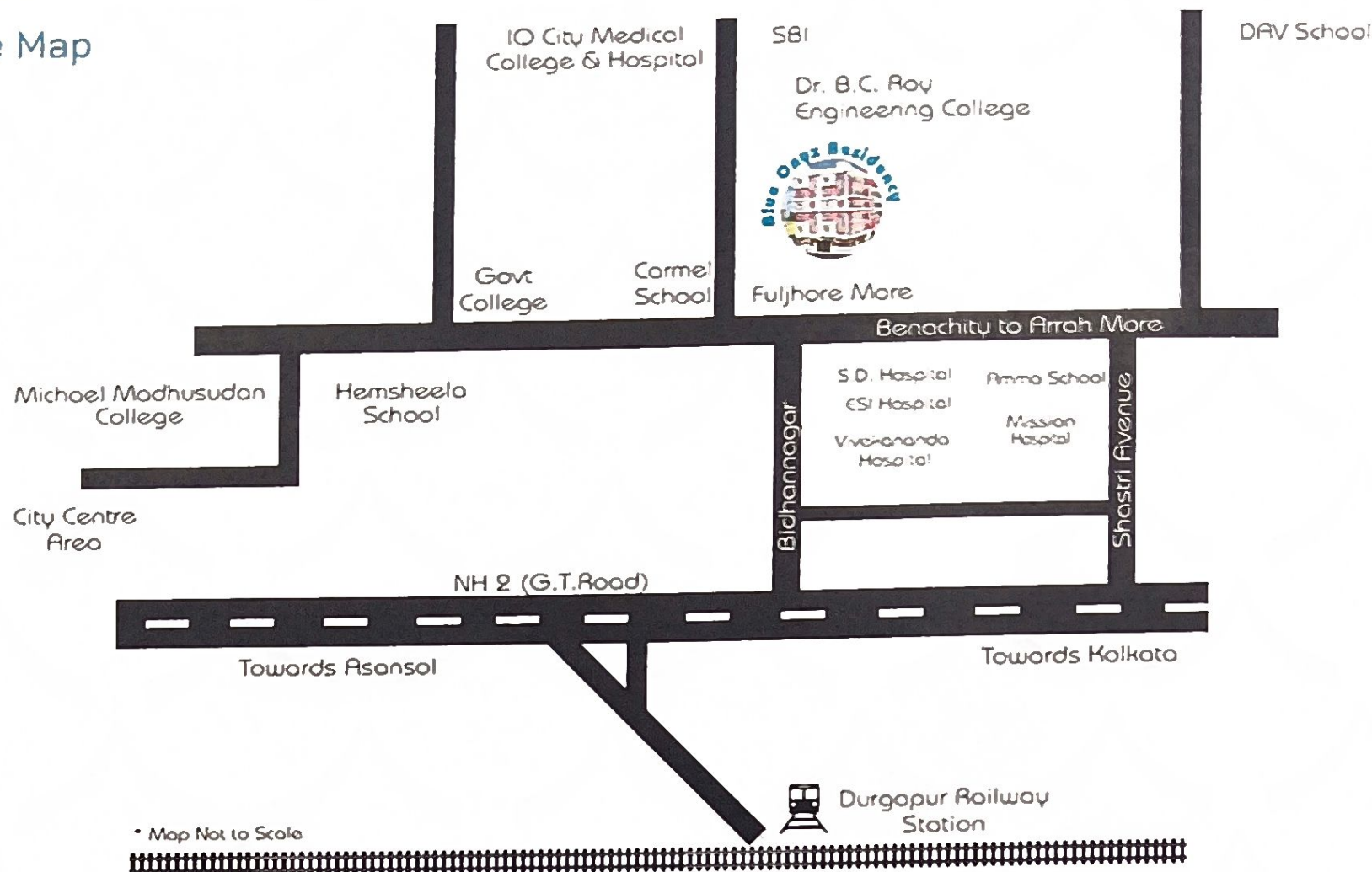

**Site Address : Fuljhore (On Main Road)  
Durgapur - 713206**

### Presented & Developed By

**BLUE ONYX PVT. LTD.**  
14/14, Bengal Ambuja, City Centre  
Durgapur - 713216  
Email - bopl2018@rediffmail.com

**Contact No. -**

**9083035555 / 9083037777**

- 1. School (English Medium) - 0.5 Km to 2 Km**  
Carmel School, St. Xaviers, DPS, DAV, St. Michael
- 2. Medical & Management College - 0.5 Km to 2 Km**  
BC Roy Engineering College, Bengal College, DSMS, IQ City Medical College, Para Medical, Govt. College, Michael Madhusudan College
- 3. Market 0.5 Km to 3 Km**  
Fuljhore, Mamra, DDA, Muchipara (NH-2), City Centre
- 4. Hospital 0.5 Km to 2 Km**  
Mission Hospital, Vivekananda Hospital, ESI Hospital, IQ City Hospital
- 5. Durgapur Railway Station - 5 Km**
- 6. Airport - 9 Km**



## Home Loan Partners

**SBI HOME LOANS**

**IDBI BANK**

**पंजाब नेशनल बैंक**  
punjab national bank

**HDFC BANK**  
We understand your world

**सेंट्रल बैंक ऑफ इंडिया**  
Central Bank of India

**AXIS BANK**

**ICICI Bank**

Disclaimer : All details in this booklet are for easy information and concept purpose only, and do not form part of the agreement. This document is tentative and developers reserve the right to make verifications and modification.